



Testing, Mitigation, System Design  
CCB 180537  
CASCARI927C1  
Fed ID 26-1809992

12839 NE Airport Way, Building 9  
Portland, Oregon 97230  
Phone: (503) 421-4813  
Fax: (503) 281-6170  
Office@CascadeRadon.com

**Radon Survey Analysis  
Job #18-C001F**

for

**Corbett School District  
Corbett High School**  
c/o Steve Salisbury

property located at

**35800 E Historic Columbia River Hwy  
Corbett, OR 97019**

February 20, 2026

**Introduction**

The following report documents a study of radon levels for the property located at 35800 E Historic Columbia River Hwy Corbett, OR 97019. The goal of this study is to determine indoor radon levels for all areas in contact with the ground. Testing performed per Oregon Health Authority School Testing Protocols.

**Analysis assumes that the buildings tested were maintained under “closed-building” conditions** (windows closed and exterior doors shut immediately after entering and exiting), as well as normal indoor temperatures, for the duration of the testing period. The H-VAC system for each building was set to normal occupied settings for the entirety of the testing period.

**Conclusions and Recommendations**

Test was a “Short-Term” test, with minimum duration of 60 hours. See the chart below of areas in buildings that were tested, and the corresponding levels found. Maps of the test levels are provided in Appendix A. Note that all Twenty-Six (26) locations tested had results below the USEPA Action Level of 4.0 pCi/L.

No mitigation action is recommended at this time. While the USEPA recommends buildings be fixed if the radon level is 4.0 pCi/L or more, because there is no known safe level of exposure to radon, the US EPA also suggests individuals consider fixing buildings for radon levels between 2.0 pCi/L and 4.0 pCi/L.

This report represents the average radon concentration for the period that testing was and at the specific location(s) within the building. The concentration of radon gas in indoor air can vary widely; it fluctuates daily, seasonally, and with weather conditions. Indoor radon levels may be affected by barometric pressure, strong winds, rain-soaked ground, snow cover, heating and A/C systems, building construction, open windows, and the like. For further confirmation of average, long-term radon levels, it is suggested that long-term, Alpha-Track type radon testing be performed.

NOTE: It is recommended from the Oregon Health Authority that any school indicating low radon values be retested at least every 10 years. In areas where mitigation has been performed, it is recommended to test using long-term testing at least every 5 years.

**Radon Level Measurements**

The building tested was assumed occupied during testing. No system was installed or inspected at the time of testing. The measurement technique used Thirty-One(31) AirChek activated charcoal kits.

Test Start Date: 2/9/2026

Test End Date: 2/13/2026

Measurements of radon levels were made in the following areas:

**Table 1: Results**

Room	Floor	Kit ID#	Test Start Time	Test End Time	Result (pCi/L)
Staff Room	1	12350183	6:00 am	8:00 am	0.6
Student Services	1	12350131	7:00 am	8:00 am	0.3
Work Room	1	12350075	6:00 am	8:00 am	0.5
Classroom 7	1	12350190	7:00 am	8:00 am	1.0
Classroom 8	1	Duplicate Avg	7:00 am	8:00 am	0.5
Private Room1	1	12350057	7:00 am	8:00 am	0.3
Private Room 2	1	12350011	7:00 am	8:00 am	0.3
Classroom 9	1	12350039	7:00 am	8:00 am	0.3
Classroom 10	1	12350066	7:00 am	8:00 am	0.3
Classroom 11	1	Duplicate Avg	7:00 am	8:00 am	0.3
Classroom 12	1	12350020	7:00 am	8:00 am	0.5

Room	Floor	Kit ID#	Test Start Time	Test End Time	Result (pCi/L)
Classroom 13	1	12279851	7:00 am	8:00 am	0.3
Classroom 14	1	12350058	7:00 am	8:00 am	0.5
Classroom 15	1	12350142	6:00 am	8:00 am	0.5
Classroom 16	1	12350064	6:00 am	8:00 am	0.3
Classroom 17	1	12350173	7:00 am	8:00 am	0.3
Classroom 18	1	12350019	7:00 am	8:00 am	0.6
Classroom 19	1	12350125	7:00 am	8:00 am	0.8
Classroom 20	1	12350015	7:00 am	8:00 am	0.6
Lunch Room	1	12350192	6:00 am	8:00 am	0.7
Maintenance Office	1	12350059	7:00 am	8:00 am	1.0
Ms. Boykins	1	12350061	7:00 am	8:00 am	0.3
Ms. Folen	1	12350184	7:00 am	8:00 am	0.3
M. Ramseyer	1	Duplicate Avg	7:00 am	8:00 am	0.6
R Quiet Room	1	12350017	7:00 am	8:00 am	0.9
R Staff Room	1	12350050	7:00 am	8:00 am	0.6

Duplicate measurements were conducted as a means to assess the precision of the test measurements. The criteria of acceptance is that the average relative percent difference (ARPD) of the results of the two measurement results for results whose averages are greater than 4.0, should be within 25%. The results of the collated duplicates are provided in Table 2. The applicable ARPD for this survey was not applicable and is thus in compliance.

**Table 2: \*Duplicate Table**

Room	Kit ID#	Test Start Time	Test End Time	Result (pCi/L)	Average (pCi/L)	Avg > 3.9 pCi/L?	RPD%
M. Ramseyer	12350063	7:00 am	8:00 am	0.5	0.6	No	33.3%
	12350144	7:00 am	8:00 am	0.7			
Classroom 8	12350024	7:00 am	8:00 am	0.6	0.5	No	66.7%
	12350150	7:00 am	8:00 am	0.3			
Classroom 11	12350060	7:00 am	8:00 am	0.3	0.3	No	0%
	12350120	7:00 am	8:00 am	0.3			
Average RPD for Duplicate Averages more than 3.9 pCi/L:							N/A
In Compliance:							Yes

As a means to determine any biases in the results, detectors were deployed but not opened. At the time of test retrieval of the regular test, the devices were removed from their packaging and sent to the laboratory for blind analysis. The results of these unexposed devices are shown in Table 3. As can be seen, the laboratory reported these at the lower level of detection, indicating that no biases were introduced in handling and shipping of the devices.

**Table 3: Blanks**

Room	Blank #	Kit ID#	Result (pCi/L)	In Compliance?
Work Room	1	12350179	0.3	Yes
Classroom 15	2	12350002	0.3	Yes

A device was also selected from the lot of detectors that were utilized for exposure to a known radon environment at a spiking chamber (Bowser-Morner, NEHANRPP ID# 101 TC). After exposure, the device was submitted as a blind measurement to the laboratory. A comparison of the reported reading from the lab and the known concentration in the chamber is as follows:

Chamber concentration to which device was exposed:	22.6 pCi/L
Concentration reported by lab:	21.7 pCi/L
Relative percent difference (RPD):	4.1%

The RPD between the reported and spiking concentration is well within normal limits.

**Key:**

pCi/L: Picocuries per liter – units of radon concentration.

Average (Avg): Cumulative average of the entire period since the test started.

Invalid: Kit is void due to being found on floor, damaged, missing, or visibly tampered with after placement

**Testing Conditions:**

Nothing of note.

**Weather:**

2/09 A.47° L.41° H.53° (Cloudy)

2/10 A.42° L.37° H.52° (Foggy)

2/11 A.48° L.41° H.56° (Mostly Sunny)



2/12 A.45° L.35° H.55° (Mostly Sunny)

2/13 A.45° L.41° H.50° (Cloudy)

Please contact me if you have any questions.

Thank you,  
Felicia Flanders  
NRPP 112059 RMP



<p><b>National Radon Proficiency Program</b></p>   <p><b>Felicia Flanders</b> Radon Measurement Professional ID Number: #112059-RMP Valid 2025-03-25 - 2027-04-30 <small>To confirm validity of this certification call 828-348-0185. Verification of adherence to state and local regulations is advised. See reverse for specific certification designations.</small></p>	<p><b>Felicia Flanders #112059-RMP</b> This individual is certified for the use of passive measurement devices to be analyzed by NRPP certified Analytical Laboratories and also certified to provide Analytical Services using the following device(s):</p> <div style="border: 1px solid black; padding: 2px;"> <p>CR-2282 SunRadon 1028-XP AT-8207 RBSI AT-101 AC-8201 Air Chek Pro Chek</p> </div> <p><small>The radon office for the state in which this person resides may be contacted for information on radon and local requirements. For additional information contact NRPP at 828-348-0185, or visit the NRPP web-site at nrpp.info <b>State Radon Program Contact Number: (971) 673-0440</b></small></p>
--	---

# Appendix A: Map of Results - Corbett High School

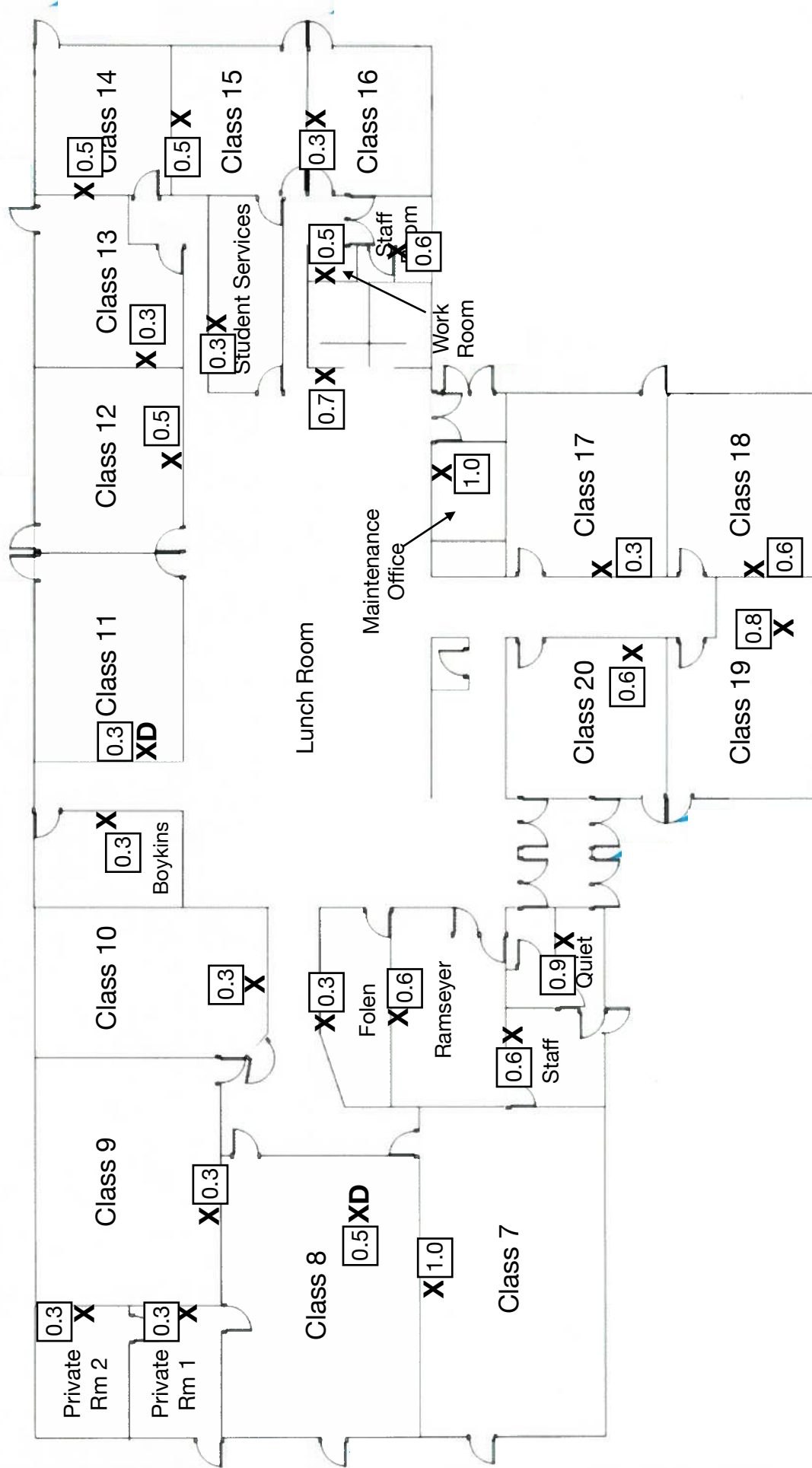

## P3606 / WADE GERVAIS

Kit Number	Start Date	Start Time	End Date	End Time	Temp.	Facility	Building	Room	Project ID	Floor	Result
12379851	2026-02-09	7:00 am	2026-02-13	8:00 am	70			CLASSROOM 13	CORBETT HIGH SCHOOL 18-C001F	1	<0.3
12350002	2026-02-09	6:00 am	2026-02-13	8:00 am	70	CORBETT HIGH SCHOOL		15	CORBETT HIGH SCHOOL 18-C001F	1	<0.3
12350011	2026-02-09	7:00 am	2026-02-13	8:00 am	70			PRIVATE ROOM 2	CORBETT HIGH SCHOOL 18-C001F	1	<0.3
12350015	2026-02-09	7:00 am	2026-02-13	8:00 am	70			CLASSROOM 20	CORBETT HIGH SCHOOL 18-C001F	1	0.6
12350017	2026-02-09	7:00 am	2026-02-13	8:00 am	70	CORBETT HIGH SCHOOL		R QUIET ROOM	CORBETT HIGH SCHOOL 18-C001F	1	0.9
12350019	2026-02-09	7:00 am	2026-02-13	8:00 am	70	CORBETT HIGH SCHOOL		18	CORBETT HIGH SCHOOL 18-C001F	1	0.6
12350020	2026-02-09	7:00 am	2026-02-13	8:00 am	70	CORBETT HIGH SCHOOL		12	CORBETT HIGH SCHOOL 18-C001F	1	0.5
12350024	2026-02-09	7:00 am	2026-02-13	8:00 am	70			CLASSROOM 8	CORBETT HIGH SCHOOL 18-C001F	1	0.6
12350039	2026-02-09	7:00 am	2026-02-13	8:00 am	70	CORBETT HIGH SCHOOL		9	CORBETT HIGH SCHOOL 18-C001F	1	<0.3
12350050	2026-02-09	7:00 am	2026-02-13	8:00 am	70			R STAFFROOM	CORBETT HIGH SCHOOL 18-C001F	1	0.6
12350057	2026-02-09	7:00 am	2026-02-13	8:00 am	70			PRIVATE ROOM 1	CORBETT HIGH SCHOOL 18-C001F	1	<0.3
12350058	2026-02-09	7:00 am	2026-02-13	8:00 am	70	CORBETT HIGH SCHOOL		14	CORBETT HIGH SCHOOL 18-C001F	1	0.5
12350059	2026-02-09	7:00 am	2026-02-13	8:00 am	70			MAINTENANCE OFFICE	CORBETT HIGH SCHOOL 18-C001F	1	1.0
12350060	2026-02-09	7:00 am	2026-02-13	8:00 am	70			CLASSROOM 11	CORBETT HIGH SCHOOL 18-C001F	1	<0.3
12350061	2026-02-09	7:00 am	2026-02-13	8:00 am	70	CORBETT HIGH SCHOOL		MS BOYKINS	CORBETT HIGH SCHOOL 18-C001F	1	<0.3
12350063	2026-02-09	7:00 am	2026-02-13	8:00 am	70	CORBETT HIGH SCHOOL		MS RAMSEYER	CORBETT HIGH SCHOOL 18-C001F	1	0.5
12350064	2026-02-09	6:00 am	2026-02-13	8:00 am	70			16	CORBETT HIGH SCHOOL 18-C001F	1	<0.3
12350066	2026-02-09	7:00 am	2026-02-13	8:00 am	70			10	CORBETT HIGH SCHOOL 18-C001F	1	<0.3
12350075	2026-02-09	6:00 am	2026-02-13	8:00 am	70			WORK ROOM	CORBETT HIGH SCHOOL 18-C001F	1	0.5
12350120	2026-02-09	7:00 am	2026-02-13	8:00 am	70			CLASSROOM 11	CORBETT HIGH SCHOOL 18-C001F	1	<0.3
12350125	2026-02-09	7:00 am	2026-02-13	8:00 am	70			CLASSROOM 19	CORBETT HIGH SCHOOL 18-C001F	1	0.8
12350131	2026-02-09	7:00 am	2026-02-13	8:00 am	70	CORBETT HIGH SCHOOL		STUDENT SERVICES	CORBETT HIGH SCHOOL 18-C001F	1	<0.3
12350142	2026-02-09	6:00 am	2026-02-13	8:00 am	70	CORBETT HIGH SCHOOL		15	CORBETT HIGH SCHOOL 18-C001F	1	0.5
12350144	2026-02-09	7:00 am	2026-02-13	8:00 am	70	CORBETT HIGH SCHOOL		MS RAMSYER	CORBETT HIGH SCHOOL 18-C001F	1	0.7
12350150	2026-02-09	7:00 am	2026-02-13	8:00 am	70			CLASSROOM 8	CORBETT HIGH SCHOOL 18-C001F	1	<0.3
12350173	2026-02-09	7:00 am	2026-02-13	8:00 am	70	CORBETT HIGH SCHOOL		17	CORBETT HIGH SCHOOL 18-C001F	1	<0.3
12350179	2026-02-09	6:00 am	2026-02-13	8:00 am	70			WORK ROOMB	CORBETT HIGH SCHOOL 18-C001F	1	<0.3
12350183	2026-02-09	6:00 am	2026-02-13	8:00 am	70			STAFF ROOM	CORBETT HIGH SCHOOL 18-C001F	1	0.6
12350184	2026-02-09	7:00 am	2026-02-13	8:00 am	70			MS FOLEN	CORBETT HIGH SCHOOL 18-C001F	1	<0.3
12350190	2026-02-09	7:00 am	2026-02-13	8:00 am	70	CORBETT HIGH SCHOOL		7	CORBETT HIGH SCHOOL 18-C001F	1	1.0
12350192	2026-02-09	6:00 am	2026-02-13	8:00 am	70	CORBETT HIGH SCHOOL		LUNCH ROOM	CORBETT HIGH SCHOOL 18-C001F	1	0.7



# Felicia Flanders

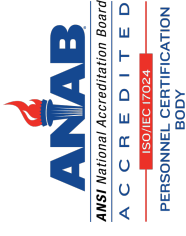

Has satisfactorily fulfilled the requirements set forth by the National Radon Proficiency Program and is therefore certified as a:

## Radon Measurement Professional

with Standard and Analytical Services

NRPP ID 112059-RMP

Issued On: 2025-03-25 Expires: 2027-04-30

Valid for specific activities or measurement devices, which can be verified with NRPP. State and local agencies may have additional requirements.



In witness Whereof,  
I have subscribed my name as a  
Representative of NRPP

Ashley Falco  
Chair, Certification Council